

# MONO RESIDENCY

# SMART HOMES

By



UNDER THE LEADERSHIP OF  
**MAS GROUP**  
THE URBANIST



## MONO RESIDENCY

is a fully separate, independent unit comprising of 2 bedrooms, living room with open kitchenette, a terrace and a car porch of standardsize. This variant of the smart homes is designed considering maximum privacy and independence.

**"INDULGE IN PEACEFUL INDEPENDANCE."**

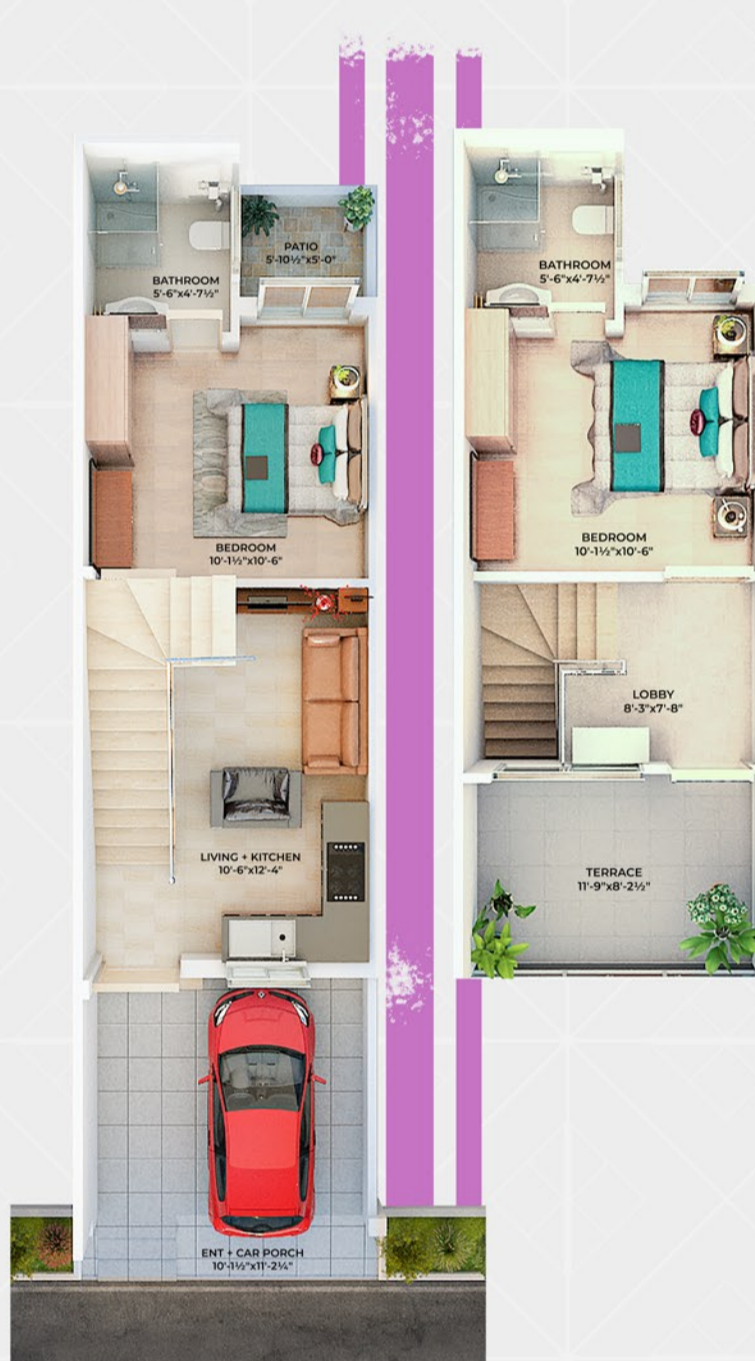

TOTAL AREA:  
**925.25 sqft**

COVERED AREA:  
**683.98 sqft**

## PAYMENT PLAN

### MONO Residency

| TYPE →        |                     |  | ECONOMY   | PREMIUM   |
|---------------|---------------------|--|-----------|-----------|
| Months        | Payment Description | Stage Description                                |           |           |
| 0             | Down Payment        |  | 783,250   | 825,500   |
| 1             | Confirmation        | Allocation of Unit                               | 907,125   | 956,000   |
| 2             | Installment         | Excavation & Termite Proofing                    | 34,875    | 36,750    |
| 3             | Installment         | DPC  | 34,875    | 36,750    |
| 4             | Installment         | Brick work Ground Floor up till Super Struction  | 34,875    | 36,750    |
| 5             | Installment         | Brick work Ground Floor up till Super Struction  | 34,875    | 36,750    |
| 6             | Installment         | Slab works Ground Floor & Brick work First Floor | 34,875    | 36,750    |
| 7             | Installment         | Brick work First Floor Super Structure           | 34,875    | 36,750    |
| 8             | Balloon Payment     | Slab works First Floor & Brick work First Floor  | 806,125   | 849,500   |
| 9             | Installment         | Slab Wrok First Floor & Stairs Work              | 34,875    | 36,750    |
| 10            | Installment         | Stair Work, Elec Works (20%) & P.H (25%)         | 34,875    | 36,750    |
| 11            | Installment         | Plaster & Parapet Wall & Floor PCC               | 34,875    | 36,750    |
| 12            | Installment         | Floor PCC & Ceiling                              | 34,875    | 36,750    |
| 13            | Installment         | Ceiling & Doors Windows & MS Grill               | 34,875    | 36,750    |
| 14            | Installment         | Doors, Windows & MS Grill, Floor Tiles           | 34,875    | 36,750    |
| 15            | Installment         | Floor Tiles / Marble                             | 34,875    | 36,750    |
| 16            | Balloon Payment     | Paint Works                                      | 930,000   | 980,000   |
| 17            | Installment         | Wood Work & Electrical Work (80%)                | 34,875    | 36,750    |
| 18            | Installment         | Electrical Work ( 80%) Public Health (75%)       | 34,875    | 36,750    |
| 19            | Installment         | Public Health ( 75%) & MS Work                   | 34,875    | 36,750    |
| 20            | Installment         | Complete   | 34,875    | 36,750    |
| 21            | Installment         | Complete   | 34,875    | 36,750    |
| 22            | Installment         | Complete   | 34,875    | 36,750    |
| 23            | Installment         | Complete   | 34,875    | 36,750    |
| 24            | Balloon Payment     | Complete   | 930,000   | 980,000   |
| Total Payment |                     |  | 5,054,000 | 5,326,000 |



PAKISTAN

info@easternhousing.com.pk

www.facebook.com/EasternHousingLahore

www.easternhousing.com.pk

UAN: 042-111-627-000

@easternhousing.pakistan

0300-0645924 | 0300-0645926

UNITED KINGDOM

muhammad.faisal@easternhousing.com.pk

0044-7830-125826